

# Dr.Coffee Machine F11 Start Up Instructions

First Step: Assemble accessories: (details refer to instruction manual)

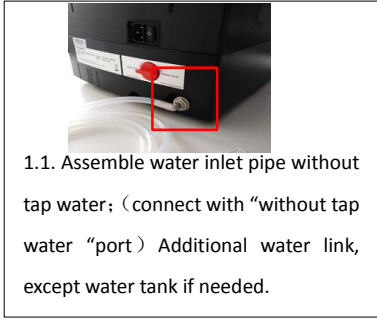

1.1. Assemble water inlet pipe without tap water; (connect with “without tap water “port) Additional water link, except water tank if needed.

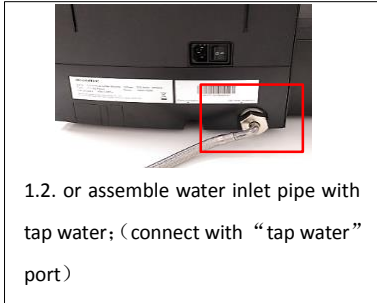

1.2. or assemble water inlet pipe with tap water; (connect with “tap water” port)

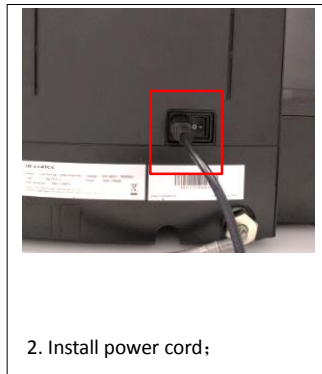

2. Install power cord;

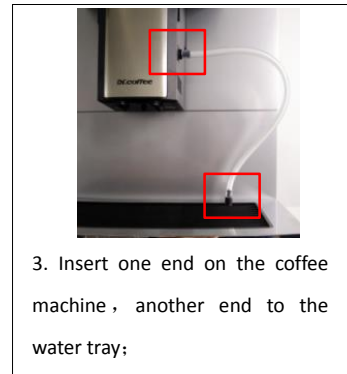

3. Insert one end on the coffee machine, another end to the water tray;

Second Step: Fill water tank; (Attention: **First boot ,the machine default setting of water supply is water tank** )



1. Open the cover;

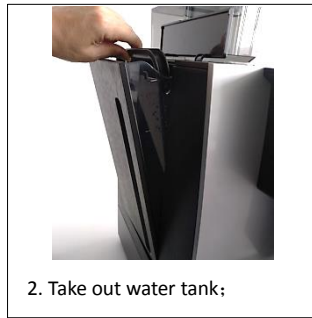

2. Take out water tank;



3. Fill water tank;

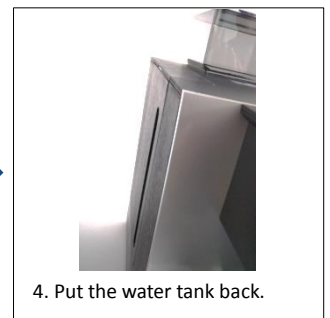

4. Put the water tank back.

Third Step: Start up;

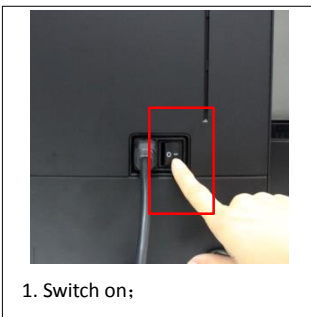

1. Switch on;

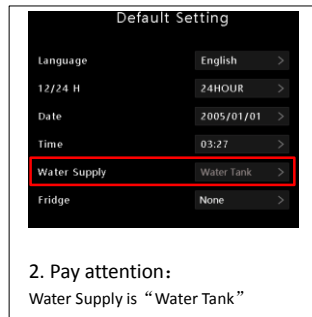

2. Pay attention:  
Water Supply is “Water Tank”

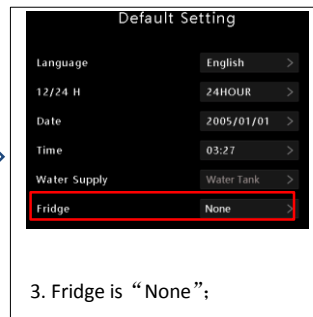

3. Fridge is “None”;



3. The interface after starting up.

Fourth Step: change the water supply; (If the machine need external water ,follow below process )



1. Touch “service manual” 5 seconds then input password “1609”;

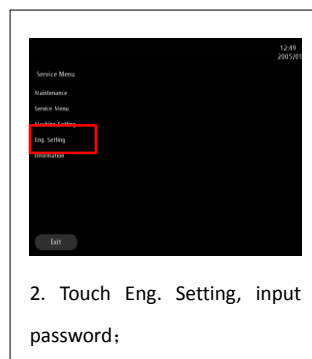

2. Touch Eng. Setting, input password:

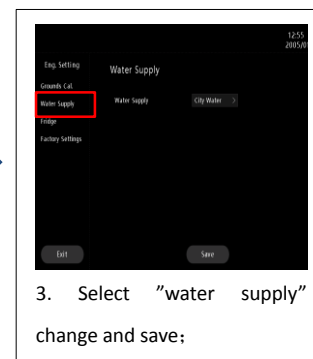

3. Select “water supply” change and save;

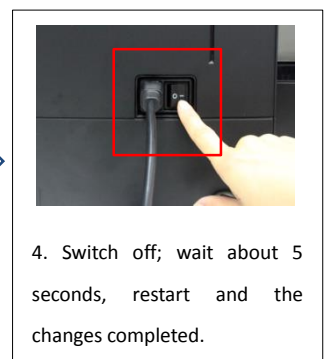

4. Switch off; wait about 5 seconds, restart and the changes completed.

**Remark:** Eng. Setting password: hour number addition, minute number addition (For example: current time 13:05, 1+3=04、0+5=05, the code is : 0405)